

SE 1/4 OF NE 1/4 OF NE 1/4
SECTION 23, T5N, R2W, S.L.B. & M.

IN ROY CITY
SCALE 1" = 60'

TAXING UNIT: 41

SEE PAGE 101

SEE PAGE 113

NOTE:
MUNICIPAL ACRES
SUBDIVISION LINE

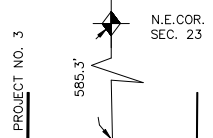

ROY CITY CENTRE
SEE PAGE 340

REDEVELOPMENT

CENTER

90'

MOUNTAIN GROVE
LLC

091020016

90'

5700 SOUTH STREET

50'

ST

WEST

2000

ROY CITY
091020005

198'

122'

66'

30'

R=20'

N 0°10'E
112.10'

25'

5'

181'

132'

N 0°10'E

138'

132'

S 0°10'W

138'

116'

105'

R=20'
L=31.42'

CNW INC
091020015

CEF FUNDING II LLC
091020002
16,414 SQ FT

PERRY-HILL ENTERPRISES, INC DBA ETAL
15091020020 1875 SQ FT

BANK OF UTAH
091020004
12,081 SQ FT

LEON H WHITE
& WF LEONE B
091020008

CHRISTY STRAIN &
JAMIE STRAIN
091020010
17,358 SQ FT

STEVEN GREER
& WF CHERYL
091020013
13,200 SQ FT

NIELSEN PROPERTY INC
091020007

ANDERSON LUMBER
091020018
13,200 SQ FT

ANDERSON LUMBER CO
091020019
12,210 SQ FT

JENSAR LLC
091020011
13,200 SQ FT

KIRK DYE
KIRK'S CAR CARE, INC
091020014
13,200 SQ FT

STREET

WEST

1900

STATE ROAD COMM
091020009

50'

50'

PROJECT NO. 3

585.3'

N.E. COR.
SEC. 23

SEE PAGE 93

SEE PAGE 140

SEE PAGE 103